

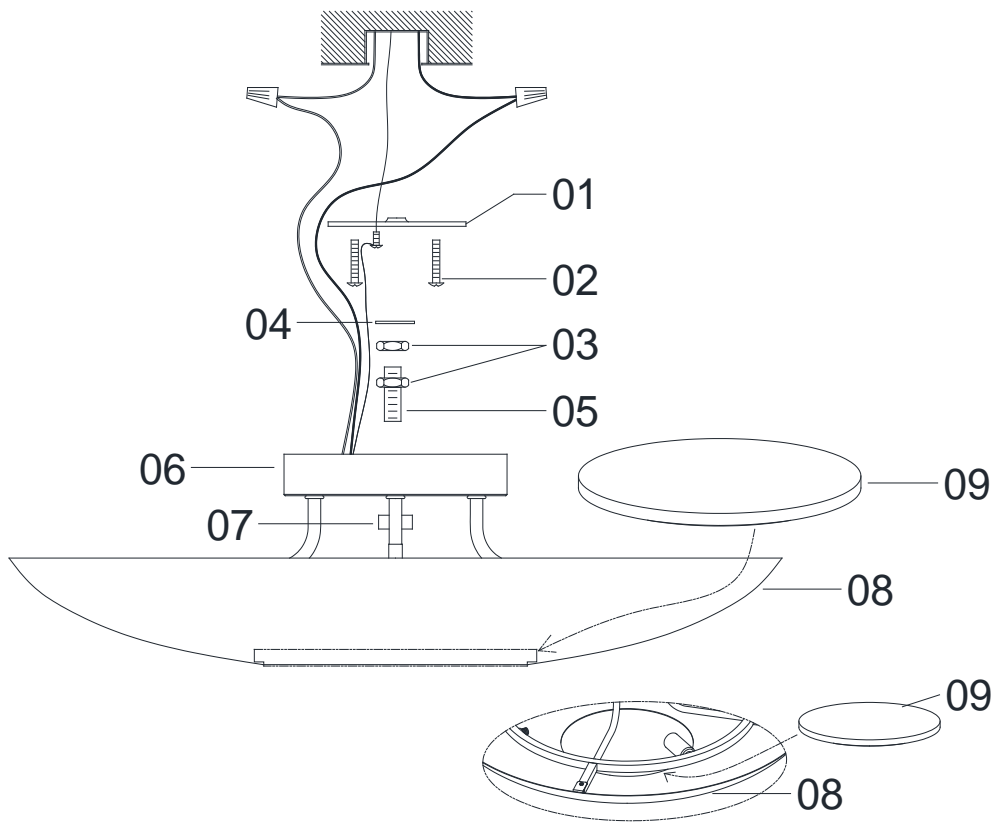

## ASSEMBLY AND INSTALLATION INSTRUCTIONS for the **257741** Fixture

### Important Safety information (Please read before proceeding)

1. Remove the fixture, parts and all mounting hardware bags (orange) from the carton and verify that all parts are present according to the illustration sheet. All parts must be used as indicated. Do not replace any parts, leave any parts out, or use any parts which are worn out or broken. **Failure to follow the instructions could cause a hazardous situation, voids the warranty and violates the U.L. listing of the fixture.**
2. To prevent the electric shock, turn off the main power at the circuit breaker before installing the fixture. **NEVER attempt to install, clean or replace bulbs without shutting off the electricity to the fixture.**
3. **Never use light bulbs with wattage ratings that exceed the fixtures maximum rating.** Always make sure the electric current is turned off before changing the bulbs.
4. If you experience difficulties installing the lighting fixture or it fails to work as expected, please contact a local qualified licensed electrical contractor.
5. Please contact your local Capital Lighting Fixture reseller with any assembly or installation questions. Your local reseller can also provide you with replacement parts for your new fixture.



### Components

1. Mounting Bar w/Green Screw
2. Outlet Box Mounting Screws
3. Hex Nut
4. Washer
5. Nipple
6. Fixture
7. Décor Knob
8. Metal Shade
9. Alabaster Diffuser

### Assembly Instructions for the 257741 fixture

1. Take Nipple (5) from parts bag and run one Hex Nut (3) with Washer (4) down Nipple (5), then tighten Hex Nut (3) with Washer (4) against the Mounting Bar (1). After that, run another Hex Nut (3) down Nipple (5) to proper position. Mounting Bar (1) must be positioned with extruded thread faced into Outlet Box. Nipple (5) must protrude out the back of Mounting Bar (1).
2. Attach Mounting Bar (1) to Outlet Box with Outlet Box Mounting Screws (2).
3. Raise Fixture (6) toward outlet box, wrap fixture grounding wire around Green Screw on Mounting Bar (1), then connect it to outlet box grounding wire with wire connector supplied; connect white fixture wire to the white power supply wire with wire connector supplied; connect black fixture wire to the black power supply wire with wire connector supplied.
4. Push Canopy of Fixture (6) to ceiling, make sure mounting hole in Canopy of Fixture (6) and Nipple (5) are in line, verify all wires are securely inside Canopy of Fixture (6), and then secure Fixture (6) to ceiling by screwing Decor Knob (7) against Canopy of Fixture (6).
5. Place Alabaster Diffuser (9) to the bottom level of Decor Shade (8) as illustration shown.